

Apple Mail – Email setup guide

If any of any of the following is unclear or does not work, please call our technical support team on 01608 434 000.

1. Open Safari and enter "c.myphone.coop" in to the address bar then click enter.



2. A login screen will pop up, please enter your full email address in the box labelled "Name" and your password in the labelled "Password" and then click the Log In button.

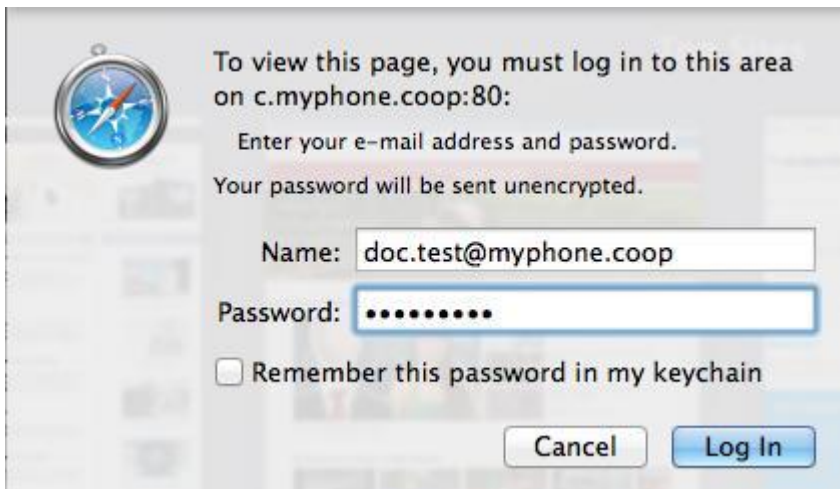

3. Click continue on the installation window that pops up.



4. Enter your full name as you would like it to appear in emails you send out and press "Install".

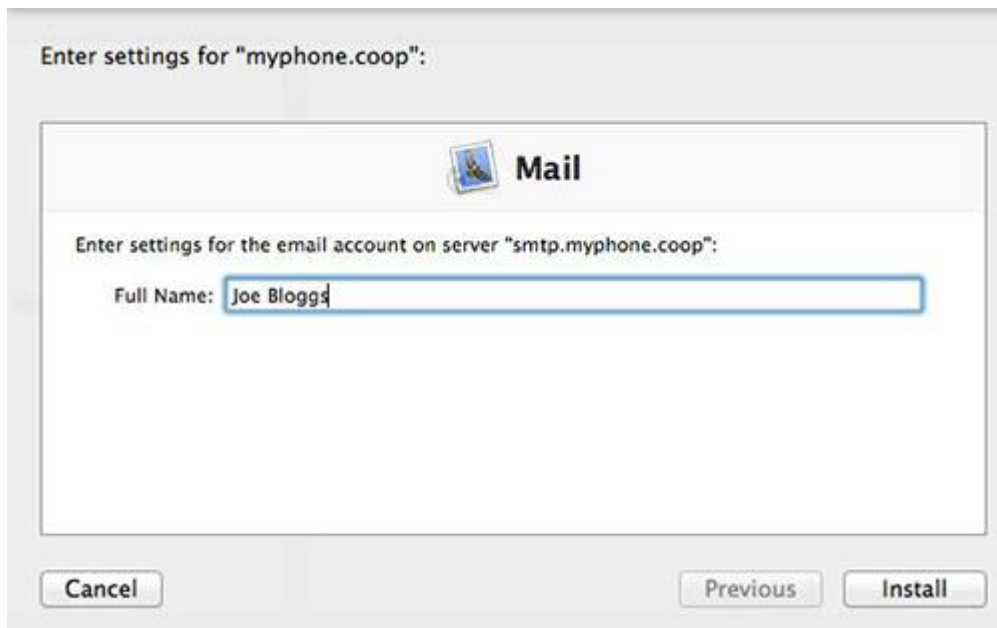

5. Open Mac Mail and your address should be all set up.